



CONTACTOR SIZE 14, 3-POLE AC-3, 335KW,
400/380V (690V) AUXILIARY CONTACTS 44 (4NO+4NC)
AC OPERATION AC 200 TO 240V 50/60HZ

General details:

| | | |
|---|----|------------|
| Size of the contactor | | 14 |
| Protection class IP / on the front | | IP00 |
| Ambient temperature / during operating | °C | 55 ... -25 |
| Item designation / according to DIN 40719 extendable after IEC 204-2 / according to IEC 750 | | K |
| Item designation / according to DIN EN 61346-2 | | Q |

Main circuit:

| | | |
|--|----|-----|
| Number of poles / for main current circuit | | 3 |
| Operating current / at AC-1 / at 400 V | | |
| • at 40 °C ambient temperature / rated value | A | 700 |
| Number of NC contacts / for main contacts | | 0 |
| Number of NO contacts / for main contacts | | 3 |
| Operating current / at AC-3 / at 400 V / rated value | A | 630 |
| Service power | | |
| • at AC-3 / at 400 V / rated value | kW | 335 |
| • at AC-1 / at 400 V / rated value | kW | 415 |

Control circuit:

| | | |
|----------------------|--|--------------|
| Design of activation | | conventional |
|----------------------|--|--------------|

| | | |
|---|----|-----|
| Type of voltage / of the controlled supply voltage | | AC |
| Control supply voltage frequency | | |
| • 1 / rated value | Hz | 50 |
| • 2 / rated value | Hz | 60 |
| Control supply voltage / 1 / at 50 Hz / for AC | | |
| • initial rated value | V | 200 |
| • final rated value | V | 240 |
| Control supply voltage / 1 / at 60 Hz / for AC | | |
| • initial rated value | V | 200 |
| • final rated value | V | 240 |

Auxiliary circuit:

Number of NC contacts / for auxiliary contacts

- lagging switching
- instantaneous switching

0
4

Number of NO contacts / for auxiliary contacts

- leading switching
- instantaneous switching

0
4

Connection type:

Design of the electrical connection

- for main current circuit
- for auxiliary and control current circuit

screw-type terminals
screw-type terminals

Identification number and letter for switching elements

44

Mechanical design:

Type of mounting

screw fixing

Type of fixing/fixation / series installation

Yes

Width

mm 230

Height

mm 232

Depth

mm 237

Certificates/approvals:

General Product Approval

**Functional Safety /
Safety of
Machinery**



CCC



CSA



GOST



UL



UR

[Type Examination](#)

**Declaration of
Conformity**

Test Certificates



EG-Konf.

[Special Test
Certificate](#)

[Type Test
Certificates/Test
Report](#)

Shipping Approval



GL



LRS



PRS



RMRS

other

[Confirmation](#)

[Declaration of
Conformity](#)

[other](#)



UL

Further information:

Information- and Downloadcenter (Catalogs, Brochures,...)

<http://www.siemens.com/industrial-controls/catalogs>

Industry Mall (Online ordering system)

<http://www.siemens.com/industrial-controls/mall>

CAX-Online-Generator

<http://www.siemens.com/cax>

Service&Support (Manuals, Certificates, Characteristics, FAQs,...)

<http://support.automation.siemens.com/WW/view/en/3TF6844-0CM7/all>

Image database (product images, 2D dimension drawings, 3D models, device circuit diagrams, ...)

http://www.automation.siemens.com/bilddb/cax_en.aspx?mlfb=3TF6844-0CM7

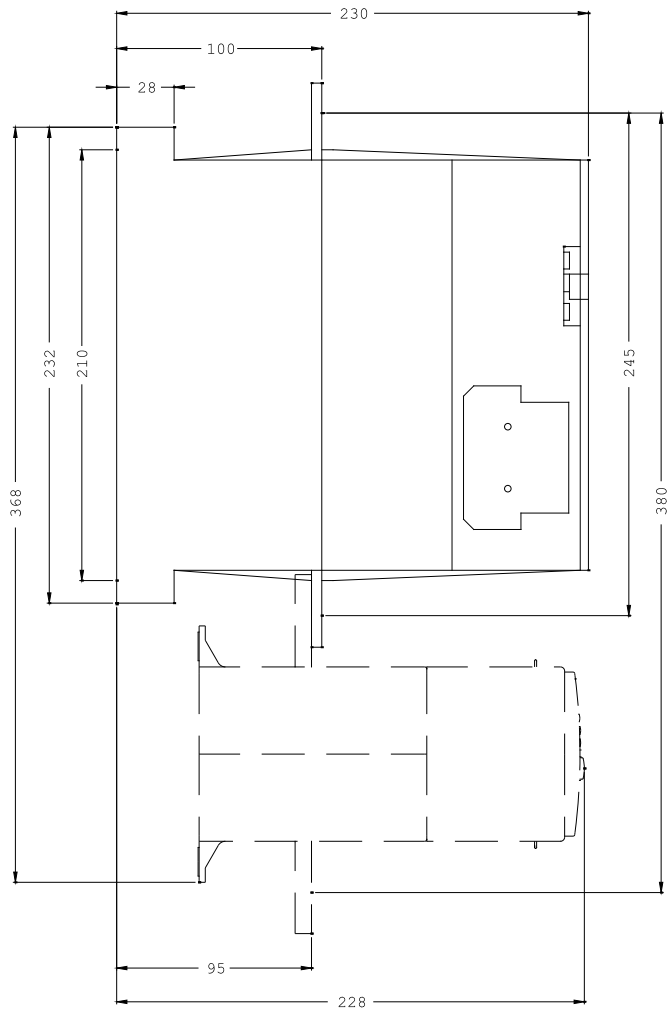
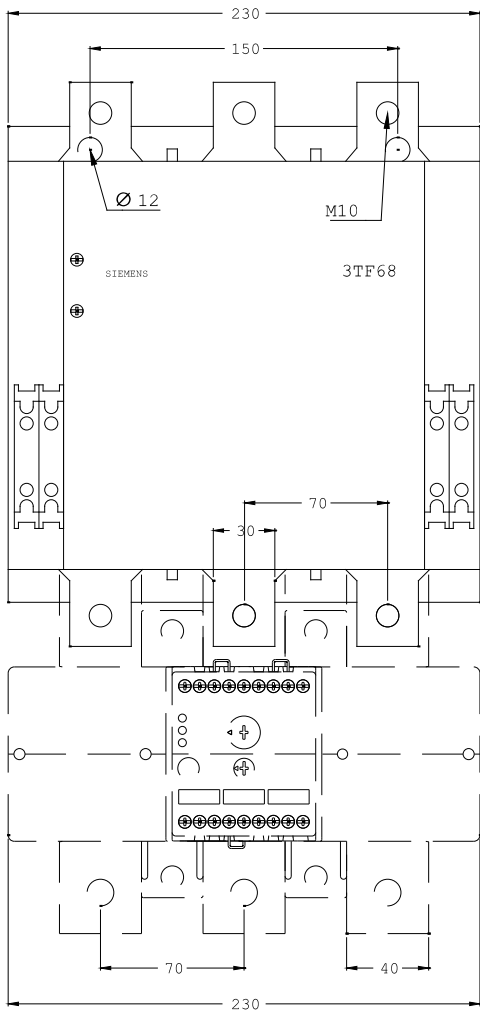

last change:

Apr 28, 2012